

1.View and size(视图及尺寸)

Main technical indicators(主要技术指标)	
1.Mating (插拔次数)	5000
2.Working Temperature (温度)	-55~+150 °C
3.IP Rating (防护级别)	IP 50
4.Diameter of socket end(插合端直径)	$\frac{8-\phi 13}{1-27}$
5.Testing Voltage (测试电压)	$\frac{1350}{1350}V$
6.Working Voltage (工作电压)	$\frac{1050}{1050}V$
7.Rated Current (额定电流)	$\frac{6A}{15A}$
8.Shell material(壳体材质)	Brass (chromium plating)/(nickel plating) fixation ring/黄铜(镀铬)/(镀镍)固定圈
9.Pin Material(插针材料)	Copper alloy gold plating(铜合金镀金)
10.Insulator material(绝缘体材质)	PPS

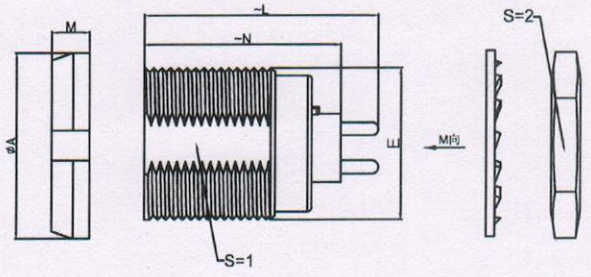

	A	N	L	E	M	S1	S2
MM	ø24	25	28.5	M18*1	4.5	16.5	22
in	0.94	0.98	1.12		0.18	0.65	0.87

Sum up(总结)

Series(系列)	B
Shell style/model (外壳样式/型号)	ZCG:With two nuts (fixed back and forth)带有两个螺母(前后固定)
Button (按键)	A button(一个按键)
Termination type (终止类型)	Female print PCB(印刷PCB)
Line diameter awg(线材直径)	28-20AWG
Cable diameterφ (电缆直径)	0-0
Match plug(匹配插头)	TGG.3B.P09.CLAD92H

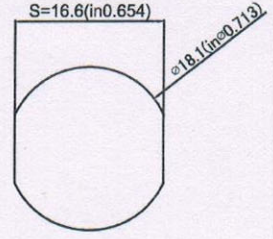
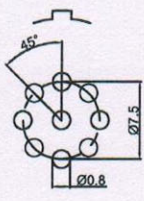

Pcb plate opening size (PCB板开孔尺寸)

Pane hole size (面板开孔尺寸)

Location pin combination (定位销组合)

(编号) Number	Number of positioning pins(定位销数量)	Angle(角度)	Series(系列)-3B
G	One(1)	A	(Zero degrees)0°
A	Two(2)		Thirty degrees(30°)
B	Two(2)		Forty-five degrees(45°)
C	Two(2)	Y	Sixty degrees(60°)
D	Two(2)		95 degrees (95°)
E	Two(2)	β	120 degrees(120°)
F	Two(2)		145 degrees(145°)
J	Two(2)	A	37.5degrees(37.5°)
K	Two(2)		52.5degrees(52.5°)
L	Two(2)		Seventy degrees(70°)

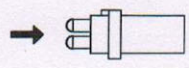

Boarded mother adhesive core (板接型母胶芯)

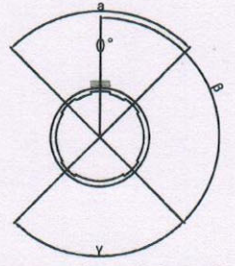

Positive view of the socket (插座正视图)

ZC G.3B.P09.C L N

- Model(型号)
- Positioning pin(定位销)
- Series(系列)
- Needle core configuration(针芯配置)
- Outer casing(外壳)
- Insulator(绝缘体)
- Needle core(针芯)

	A	B	C√	ANGLE	
5-10	±0.02	±0.05	±0.1	0°-30°	±0.1°
50-100	±0.1	±0.15	±0.2	61°-90°	±0.5°
50-100	±0.15	±0.2	±0.25		
100-	±0.15%	±0.20%	±0.25%		



DESIGNED (设计)	DATE(日期)	SCALE(比例)	N/A(不适用)	MODEL TYPE 型号类型: ZCG.3B.P09.CLN
CHECKED (校对)	DATE(日期)	VIEW(视图)		PART NO. 3B9 core socket 名称: 3B9芯插座
APPROVED (审核)	DATE(日期)	UNIT(单位)	MM	DWG NO.:
REVISIONS				
www.helloxkb.com www.helloxkb.cn				XKB INDUSTRIAL PRECISION CO.,LIMITED
		WEIGHT(重量)	SHEET(表)	REVISION(修订)
			1/1	A0