

# 1.View and size(视图及尺寸)

| Main technical indicators(主要技术指标) |  |
|-----------------------------------|--|
| 1.Mating (插拔次数)                   | 5000   |
| 2.Working Temperature (温度)        | -55~+150 ℃   |
| 3.IP Rating (防护级别)                | IP 50  |
| 4.Diameter of socket end(插合端直径)   | φ0.5   |
| 5.Testing Voltage (测试电压)          | 600V   |
| 6.Working Voltage (工作电压)          | 500V   |
| 7.Rated Current (额定电流)            | 2.0A   |
| 8.Shell material(壳体材质)            | Brass (chromium plating)/(nickel plating) fixation ring/ 黄铜 (镀铬) /(镀镍) 固定圈 |
| 9.Pin Material(插针材料)              | Copper alloy gold plating(铜合金镀金)   |
| 10.Insulator material(绝缘体材质)      | PPS  |

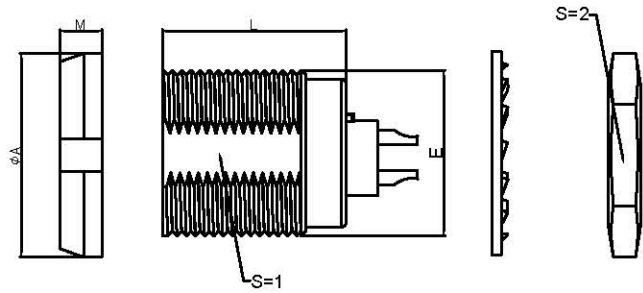

|    | A    | L    | E      | M    | S1   | S2   |
|----|------|------|--------|------|------|------|
| MM | φ12  | 14.5 | M9*0.6 | 2.5  | 8.2  | 11   |
| in | 0.47 | 0.57 |        | 0.01 | 0.32 | 0.43 |

| Sum up(总结)                  |   |
|-----------------------------|---|
| Series(系列)                  | B   |
| Shell style/model (外壳样式/型号) | ZCG:With two nuts (fixed back and forth)带有两个螺母 (前后固定) |
| Button (按键)                 | A button(一个按键)  |
| Termination type (终止类型)     | Mother solder tin(母焊锡)                                |
| Line diameter awg(线材直径)     | 34AWG-28AWG   |
| Cable diameterφ (电缆直径)      | 0-0   |
| Match plug(匹配插头)            | TGG.0B.P09.CLAD52H                                    |

| Location pin combination (定位销组合) |                                   |           |                         |
|----------------------------------|-----------------------------------|-----------|-------------------------|
| (编号) Number                      | Number of positioning pins(定位销数量) | Angle(角度) | Series(系列)--0B          |
| G                                | One(1)                            |           | (Zero degrees)0°        |
| A                                | Two(2)                            | A         | Thirty degrees(30°)     |
| B                                | Two(2)                            |           | Sixty degrees(60°)      |
| C                                | Two(2)                            |           | Ninety degrees(90°)     |
| D                                | Two(2)                            | β         | 135 degrees(135°)       |
| E                                | Two(2)                            |           | 145 degrees(145°)       |
| F                                | Two(2)                            |           | 155 degrees(155°)       |
| J                                | Two(2)                            | γ         | Forty-five degrees(45°) |
| K                                | Two(2)                            |           | Seventy degrees(70°)    |
| L                                | Two(2)                            |           | 80 degrees(80°)         |

|        | A      | B      | C√     | ANGLE   |       |
|--------|--------|--------|--------|---------|-------|
| 5-10   | ±0.02  | ±0.05  | ±0.1   | 0°-30°  | ±0.1° |
| 50-100 | ±0.1   | ±0.15  | ±0.2   | 61°-90° | ±0.5° |
| 50-100 | ±0.15  | ±0.2   | ±0.25  |         |       |
| 100-   | ±0.15% | ±0.20% | ±0.25% |         |       |

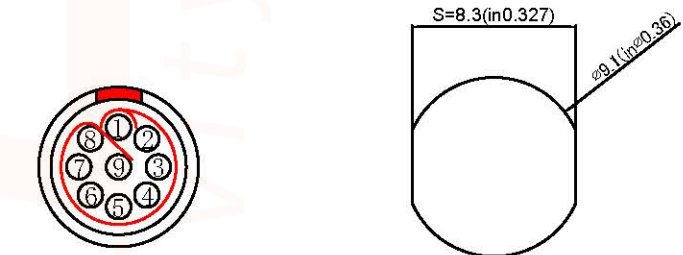

Welded surface (焊接面)

Panel hole size (面板开孔尺寸)

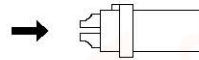

(Welded mother adhesive core) 焊接型母胶芯

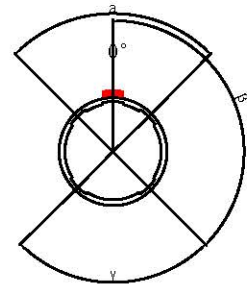

Positive view of the socket (插座正视图)

ZC G.0B.P09.C L L

- Model(型号)
- Positioning pin(定位销)
- Series(系列)
- Needle core configuration(针芯配置)
- Outer casing(外壳)
- Insulator(绝缘体)
- Needle core(针芯)

|                                  |          |           |                                      |  |
|----------------------------------|----------|-----------|--------------------------------------|--|
| DESIGNED (设计)                    | DATE(日期) | SCALE(比例) | N/A(不适用)                             | MODEL TYPE                             |
| CHECKED (校对)                     | DATE(日期) | VIEW(视图)  |                                      | 型号类型: ZCG.0B.P09.CLL                   |
| APPROVED (审核)                    | DATE(日期) | UNIT(单位)  | MM                                   | PART NO. 0B9-core socket<br>名称: 0B9芯插座 |
| REVISIONS                        |          |           | MATERIAL (材料)                        | DWG NO.:                               |
| www.helloxkb.com www.helloxkb.cn |          |           | XKB INDUSTRIAL PRECISION CO.,LIMITED | WEIGHT(重量) SHEET(表) REVISION(修订)       |
|                                  |          |           |                                      | 1/1 A0                                 |