

1.View and size(视图及尺寸)

| Main technical indicators(主要技术指标) |  |
|-----------------------------------|--|
| 1.Mating (插拔次数)                   | 5000   |
| 2.Working Temperature (温度)        | -55~+150 °C  |
| 3.IP Rating (防护级别)                | IP 50  |
| 4.Diameter of socket end(插合端直径)   | φ0.7   |
| 5.Testing Voltage (测试电压)          | 1000V  |
| 6.Working Voltage (工作电压)          | 900V   |
| 7.Rated Current (额定电流)            | 5.5A   |
| 8.Shell material(壳体材质)            | Brass (chromium-plated) shell and nut/(nickel-plated) lock sleeve and middleware/黄铜(镀铬)锁套筒和中间件 |
| 9.Pin Material(插针材料)              | Copper alloy gold plating(铜合金镀金)   |
| 10.Insulator material(绝缘体材质)      | PPS  |

| Sum up(总结)                  |   |
|-----------------------------|---|
| Series(系列)                  | B   |
| Shell style/model (外壳样式/型号) | MHG.Floating socket, cable chuck and nut, used to install bending relief.(浮动式插座, 电缆夹头和螺母, 用来安装弯曲救济) |
| Button (按键)                 | A button(一个按键)  |
| Termination type (终止类型)     | Mother solder tin(母焊锡)  |
| Line diameter awg(线材直径)     | 30-22AWG  |
| Cable diameterφ (电缆直径)      | φ5.3-6.2MM  |
| Match plug(匹配插头)            | TGG.3B.P22.CLAD62H  |

| Location pin combination(定位销组合) |                                   |           |                         |
|---------------------------------|-----------------------------------|-----------|-------------------------|
| (编号) Number                     | Number of positioning pins(定位销数量) | Angle(角度) | Series(系列)--3B          |
| G                               | One(1)                            |           | (Zero degrees)0°        |
| A                               | Two(2)                            | A         | Thirty degrees(30°)     |
| B                               | Two(2)                            |           | Forty-five degrees(45°) |
| C                               | Two(2)                            |           | Sixty degrees(60°)      |
| D                               | Two(2)                            | γ         | 95 degrees (95°)        |
| E                               | Two(2)                            | β         | 120 degrees(120°)       |
| F                               | Two(2)                            |           | 145 degrees(145°)       |
| J                               | Two(2)                            | A         | 37.5degrees(37.5°)      |
| K                               | Two(2)                            |           | 52.5degrees(52.5°)      |
| L                               | Two(2)                            |           | Seventy degrees(70°)    |

|        | A      | B      | C√     | ANGLE   |       |
|--------|--------|--------|--------|---------|-------|
| 5-10   | ±0.02  | ±0.05  | ±0.1   | 0°-30°  | ±0.1° |
| 50-100 | ±0.1   | ±0.15  | ±0.2   | 61°-90° | ±0.5° |
| 50-100 | ±0.15  | ±0.2   | ±0.25  |         |       |
| 100-   | ±0.15% | ±0.20% | ±0.25% |         |       |

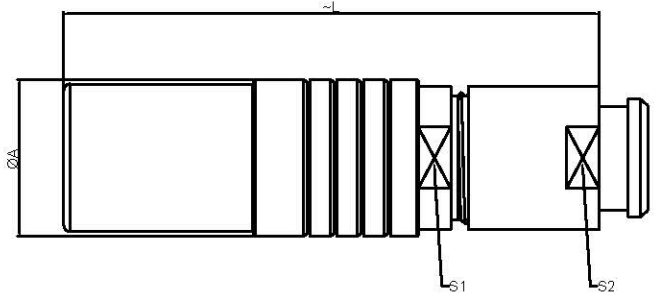

|    | φA    | L      | S1     | S2     |
|----|-------|--------|--------|--------|
| MM | φ19   | 54.5   | 15.0   | 15.0   |
| in | 0.748 | 2.1457 | 0.5905 | 0.5905 |



Welded surface (焊接面)

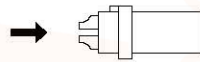

(Welded mother adhesive core) 焊接型母胶芯

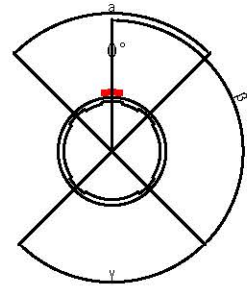

Positive view of the socket (插座正视图)

MH G. 3B. P22.C L L D 62 H

- Model(型号)
  - Positioning pin(定位销)
  - Series(系列)
  - Needle core configuration(针芯配置)
  - Outer casing(外壳)
  - Insulator(绝缘体)
  - Needle core(针芯)
  - Type of clamp(线夹类型)
  - Cable diameter(电缆直径)
- SH means a sheath type, not a cover type.  
(H表示护套型, 不表示为不带护套型)

|                                  |  |          |  |                                      |          |  |
|----------------------------------|--|----------|--|--------------------------------------|----------|--|
| DESIGNED(设计)                     |  | DATE(日期) |  | SCALE(比例)                            | N/A(不适用) | MODEL TYPE                               |
| CHECKED(校对)                      |  | DATE(日期) |  | VIEW(视图)                             |          | 型号类型: MHG.3B.P22.CLLD62H                 |
| APPROVED(审核)                     |  | DATE(日期) |  | UNIT(单位)                             | MM       | PART NO. 3B22 core socket<br>名称: 3B22芯插座 |
| REVISIONS                        |  |          |  | MATERIAL (材料)                        |          | DWG NO.:                                 |
| www.helloxkb.com www.helloxkb.cn |  |          |  | XKB INDUSTRIAL PRECISION CO.,LIMITED |          | WEIGHT(重量) SHEET(表) REVISION(修订)         |
|                                  |  |          |  |                                      |          | 1/1 A0                                   |